

SATZUNG DER STADT GREVESMÜHLEN ÜBER DEN BEBAUUNGSPLAN NR. 39 "ZUM SÄGEWERK"

FÜR DAS GEBIET SÜDLICH DES BAHNGLEISES DER STADT GREVESMÜHLEN

Es gilt das Baugesetzbuch (BauGB) in der Fassung der Bekanntmachung vom 03.11.2017 (BGBl. I S. 3634) sowie die BauNVO...

Aufgrund des § 10 des Baugesetzbuches (BauGB) und des § 86 der Landesbauordnung Mecklenburg-Vorpommern (LBAuO MV)...

TEIL A: PLANZEICHNUNG

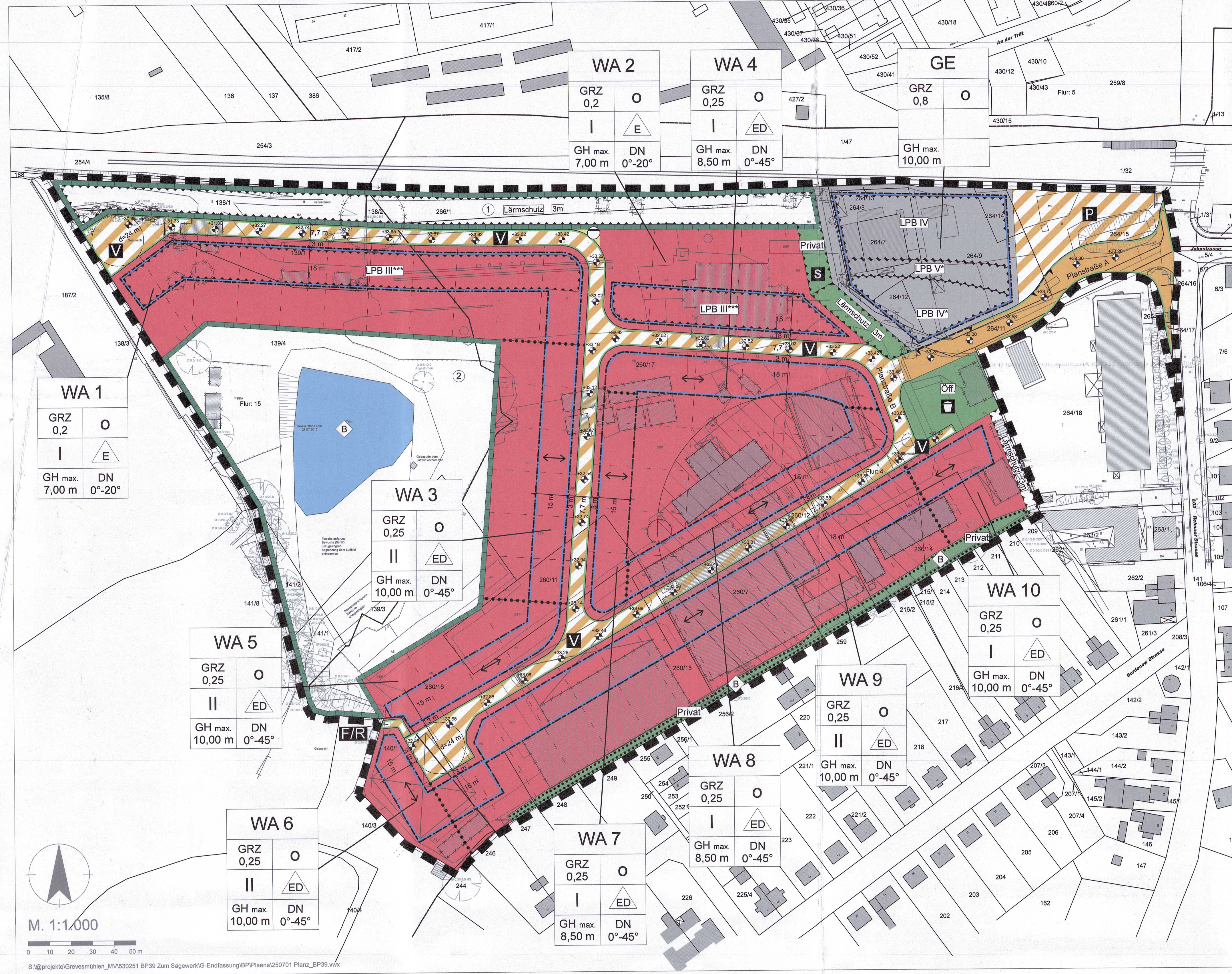

PLANZEICHENERKLÄRUNG

Legend for the planning map, including symbols for building types, zones, and technical details like height and area.

- List of regulations (1.1 to 1.5) detailing requirements for retail operations, planting of flowers, and garage/annexes.

- Regulation 2: Requirements for building use and height of structures.

- Regulation 3: Maximum number of dwellings in residential buildings.

- Regulation 4: Requirements for noise protection and connections to public spaces.

- Regulation 5: Protection against environmental impacts from noise and light.

- Regulation 6: Requirements for noise protection and connections to public spaces.

- Regulation 7: Maximum building height.

- Regulation 8: Requirements for noise protection and connections to public spaces.

- Regulation 9: Requirements for noise protection and connections to public spaces.

- Regulation 10: Requirements for noise protection and connections to public spaces.

- Regulation 11: Requirements for noise protection and connections to public spaces.

- Regulation 12: Requirements for noise protection and connections to public spaces.

- Regulation 13: Requirements for noise protection and connections to public spaces.

- Regulation 14: Requirements for noise protection and connections to public spaces.

- Regulation 15: Requirements for noise protection and connections to public spaces.

- Regulation 16: Requirements for noise protection and connections to public spaces.

- Regulation 17: Requirements for noise protection and connections to public spaces.

- Regulation 18: Requirements for noise protection and connections to public spaces.

- Regulation 19: Requirements for noise protection and connections to public spaces.

- Regulation 20: Requirements for noise protection and connections to public spaces.

- Regulation 21: Requirements for noise protection and connections to public spaces.

- Regulation 22: Requirements for noise protection and connections to public spaces.

- Regulation 23: Requirements for noise protection and connections to public spaces.

- Regulation 24: Requirements for noise protection and connections to public spaces.

- Regulation 25: Requirements for noise protection and connections to public spaces.

- Regulation 26: Requirements for noise protection and connections to public spaces.

- Regulation 27: Requirements for noise protection and connections to public spaces.

- Regulation 28: Requirements for noise protection and connections to public spaces.

- Regulation 29: Requirements for noise protection and connections to public spaces.

- Regulation 30: Requirements for noise protection and connections to public spaces.

- Regulation 31: Requirements for noise protection and connections to public spaces.

- Regulation 32: Requirements for noise protection and connections to public spaces.

- Regulation 33: Requirements for noise protection and connections to public spaces.

- Regulation 34: Requirements for noise protection and connections to public spaces.

- Regulation 35: Requirements for noise protection and connections to public spaces.

- Regulation 36: Requirements for noise protection and connections to public spaces.

- Regulation 37: Requirements for noise protection and connections to public spaces.

- Regulation 38: Requirements for noise protection and connections to public spaces.

- Regulation 39: Requirements for noise protection and connections to public spaces.

- Regulation 40: Requirements for noise protection and connections to public spaces.

- Regulation 41: Requirements for noise protection and connections to public spaces.

- Regulation 42: Requirements for noise protection and connections to public spaces.

- Regulation 43: Requirements for noise protection and connections to public spaces.

- Regulation 44: Requirements for noise protection and connections to public spaces.

- Regulation 45: Requirements for noise protection and connections to public spaces.

- Regulation 46: Requirements for noise protection and connections to public spaces.

- Regulation 47: Requirements for noise protection and connections to public spaces.

- Regulation 48: Requirements for noise protection and connections to public spaces.

- Regulation 49: Requirements for noise protection and connections to public spaces.

- Regulation 50: Requirements for noise protection and connections to public spaces.

- Regulation 51: Requirements for noise protection and connections to public spaces.

- Regulation 52: Requirements for noise protection and connections to public spaces.

- Regulation 53: Requirements for noise protection and connections to public spaces.

- Regulation 54: Requirements for noise protection and connections to public spaces.

- Regulation 55: Requirements for noise protection and connections to public spaces.

- Regulation 56: Requirements for noise protection and connections to public spaces.

- Regulation 57: Requirements for noise protection and connections to public spaces.

- Regulation 58: Requirements for noise protection and connections to public spaces.

- Regulation 59: Requirements for noise protection and connections to public spaces.

- Regulation 60: Requirements for noise protection and connections to public spaces.

- Regulation 61: Requirements for noise protection and connections to public spaces.

- Regulation 62: Requirements for noise protection and connections to public spaces.

- Regulation 63: Requirements for noise protection and connections to public spaces.

- Regulation 64: Requirements for noise protection and connections to public spaces.

- Regulation 65: Requirements for noise protection and connections to public spaces.

- Regulation 66: Requirements for noise protection and connections to public spaces.

- Regulation 67: Requirements for noise protection and connections to public spaces.

- Regulation 68: Requirements for noise protection and connections to public spaces.

- Regulation 69: Requirements for noise protection and connections to public spaces.

- Regulation 70: Requirements for noise protection and connections to public spaces.

- Regulation 71: Requirements for noise protection and connections to public spaces.

- Regulation 72: Requirements for noise protection and connections to public spaces.

- Regulation 73: Requirements for noise protection and connections to public spaces.

- Regulation 74: Requirements for noise protection and connections to public spaces.

- Regulation 75: Requirements for noise protection and connections to public spaces.

- Regulation 76: Requirements for noise protection and connections to public spaces.

- Regulation 77: Requirements for noise protection and connections to public spaces.

- Regulation 78: Requirements for noise protection and connections to public spaces.

- Regulation 79: Requirements for noise protection and connections to public spaces.

- Regulation 80: Requirements for noise protection and connections to public spaces.

- Regulation 81: Requirements for noise protection and connections to public spaces.

- Regulation 82: Requirements for noise protection and connections to public spaces.

- Regulation 83: Requirements for noise protection and connections to public spaces.

- Regulation 84: Requirements for noise protection and connections to public spaces.

- Regulation 85: Requirements for noise protection and connections to public spaces.

- Regulation 86: Requirements for noise protection and connections to public spaces.

- Regulation 87: Requirements for noise protection and connections to public spaces.

- Regulation 88: Requirements for noise protection and connections to public spaces.

- Regulation 89: Requirements for noise protection and connections to public spaces.

- Regulation 90: Requirements for noise protection and connections to public spaces.

SATZUNG DER STADT GREVESMÜHLEN ÜBER DEN BEBAUUNGSPLAN NR. 39 "ZUM SÄGEWERK"

FÜR DAS GEBIET SÜDLICH DES BAHNGLEISES DER STADT GREVESMÜHLEN

Table with project details: BERATUNGSFASHE, BERATUNGSNAME, PROJEKT-NR., PROJEKTLEITER, PROJEKTBEFORDERER, etc.

AC PLANERGRUPPE, STADTPLANER I ARCHITECTEN I LANDSCHAFTSARCHITECTEN, Burg 7 | 21524 Itehoje | 04621 882 20 | www.ac-planergruppe.de